

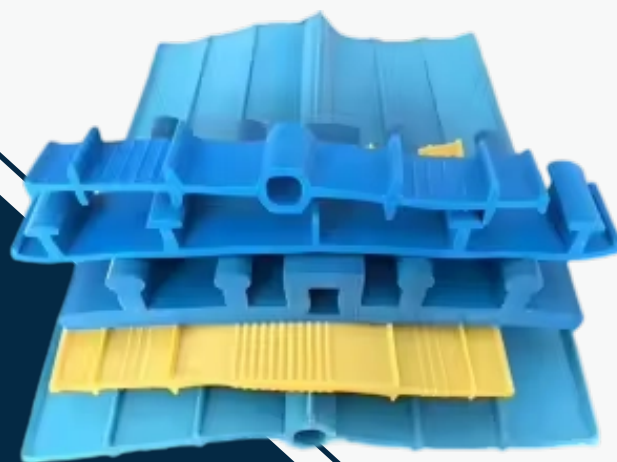

2025

Buried & Back Stick Waterstop with and without Center Bulb

Hengshui JingTong Rubber Co., Ltd.



Add: No. 11-3, Wuyi Science and Technology Enterprise Park,
Hengshui City, Hebei Province, China.

Whatsapp: +86-15731809416

Tel: +86-318-52275227

E-Mail: sales@jointwaterstop.com

Web: www.jointwaterstop.com

Center-Embedded Waterstop

Buried Waterstop Without Center Bulb

Buried waterstop without center bulb is designed to rely on the rubber body's swelling properties to seal joints and prevent groundwater infiltration. It is ideal for both expansion joints and construction joints in underground structures. This waterstop offers a concealed, durable, and low-maintenance solution for long-term waterproofing.

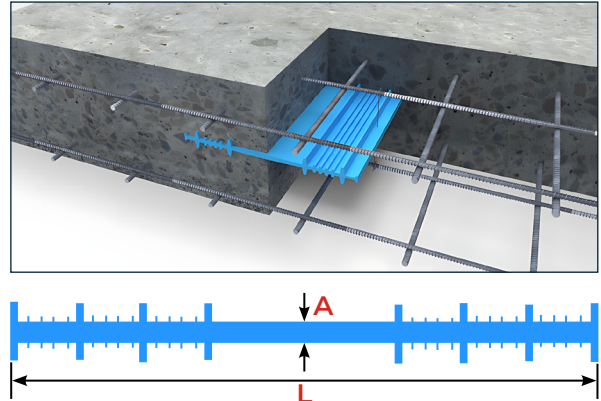

Code	A mm	B mm	C mm	D mm	Length mm	Pack mt
150	-	-	-	-	150	50/25
200	-	-	-	-	200	50/25
250	-	-	-	-	250	30
300	3.5	-	-	-	300	30

Buried Waterstop With Center Bulb

The buried waterstop with center bulb features a built-in leakage indicator that allows for visual inspection. This makes it easy to quickly identify any damage to the waterstop or water seepage after concrete pouring.

It is commonly used in tunnels, underground utility corridors, and other high-reliability waterproof joints. The design enables both self-inspection during construction and ongoing monitoring during operation, enhancing overall waterproofing assurance.

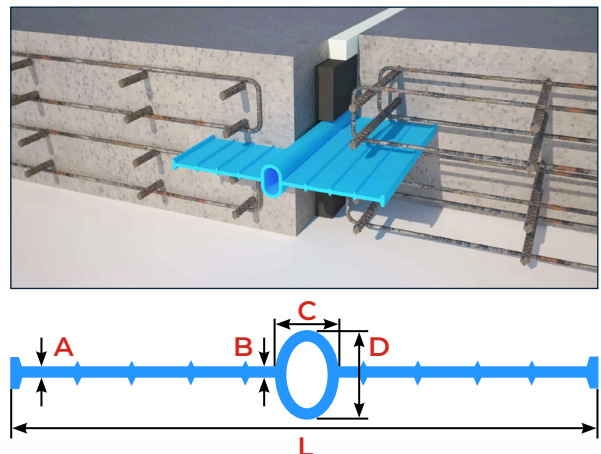

Code	A mm	B mm	C mm	D mm	Length mm	Pack mt
150 Bulb	2.3	3.5	23	27	150	25
200 Bulb	2.5	3.7	25	30	200	25
220 Bulb	2.5	3.7	25	30	220	25
250 Bulb	2.5	4	25	30	250	25
260 Bulb	2.8	5.5	25	32	260	25
300 Bulb	2.6	4	30	38	300	20
320 Bulb	3	4.5	27	32	320	20
360 Bulb	4	6.4	37	45	360	15
440 Bulb	4	8	48	48	440	15

Buried Waterstop With Center Bulb

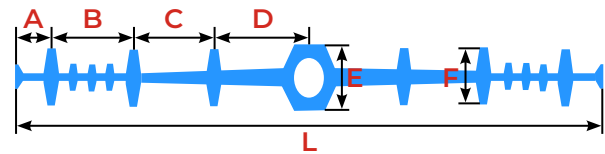
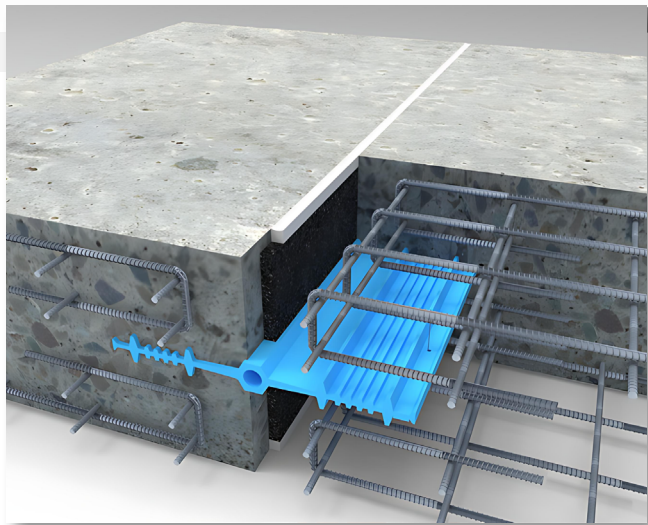

Code	A mm	B mm	C mm	D mm	E mm	F mm	Length mm
150 Bulb	20	20	-	25	20	20	150
200 Bulb	20	40	-	40	21	20	200
250 Bulb	20	50	-	55	25	25	250
320 Bulb	20	45	45	50	28	25	320

Back Stick Waterstop

Back stick waterstop without center bulb

This type of waterstop is applied by bonding it to the outer surface of the concrete joint. It relies on the elasticity of the rubber and the adhesive layer to effectively block water seepage.

It is widely used in tunnels and underground structures, especially in secondary linings and deformation joints. The design allows for convenient installation and future replacement, serving as an effective auxiliary waterproofing barrier.

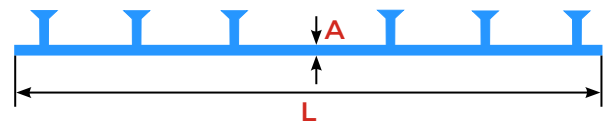
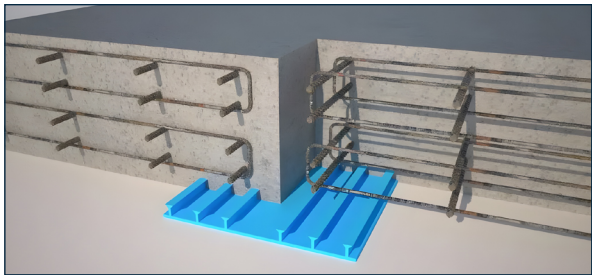

Code	A mm	B mm	C mm	D mm	Length mm	Pack mt
200	3.2	-	-	17	200	20/25
250	3.2	-	-	17	250	20/25
320	4	-	-	24	320	15

Buried Waterstop Without Center Bulb

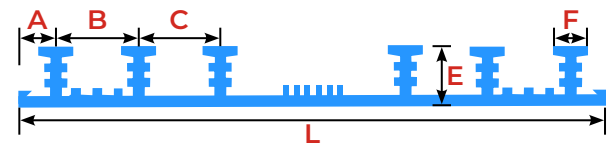
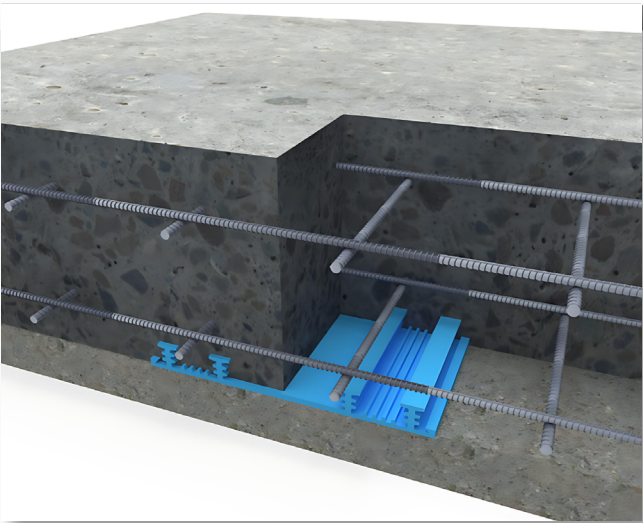

Code	A mm	B mm	C mm	D mm	E mm	F mm	Length mm
150	20	-	-	50	15	15	150
200	15	40	-	45	20	15	200
250	20	50	-	55	25	15	250
320	20	45	45	50	25	15	320

Back Stick Waterstop With Center Bulb

Back stick waterstop with center bulb is bonded to the exterior face of the concrete joint. The central bulb accommodates movement and deformation, while the rubber's elasticity and adhesive backing help block water ingress. Commonly used in tunnels, basements, and underground structures, it offers enhanced adaptability at expansion joints, reliable waterproofing, and ease of replacement during maintenance.

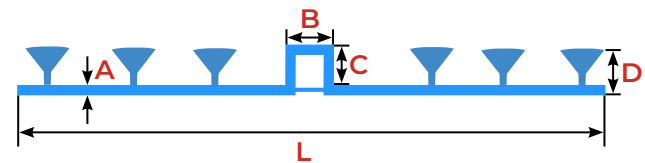
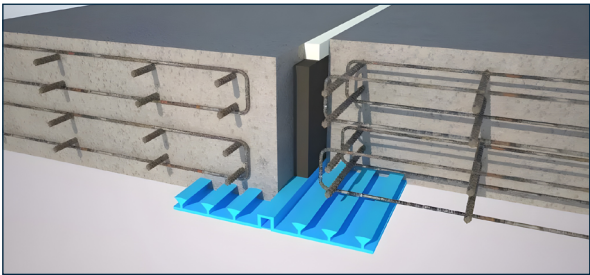

Code	A mm	B mm	C mm	D mm	Length mm	Pack mt
200 Bulb	3.2	19	20	17	200	25
250 Bulb	3.2	19	22	17	250	25
320 Bulb	4	30	30	23	320	15
350 Bulb	4.5	30	30	24	350	15
350 Bulb	5	35	35	27	350	15

Back Stick Waterstop With Center Bulb

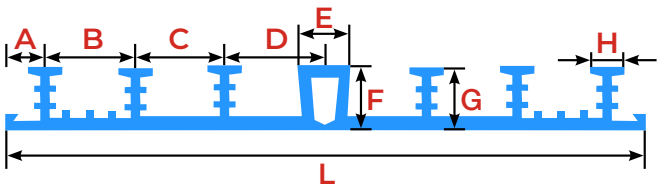
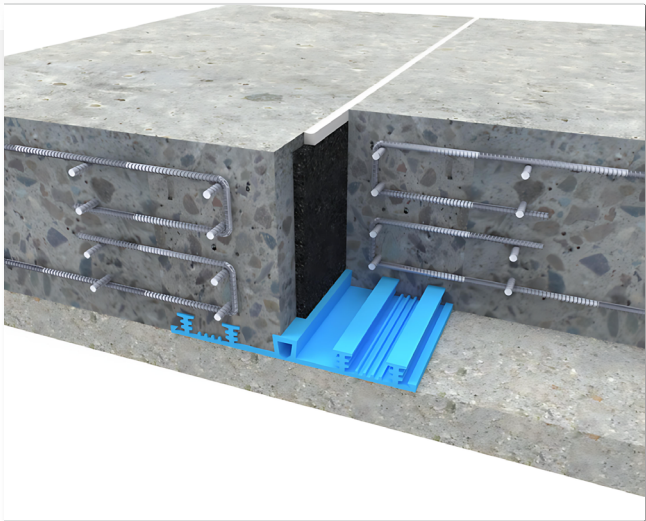

Code	A	B	C	D	E	F	G	H	Length
	mm	mm	mm	mm	mm	mm	mm	mm	mm
150	20	-	-	55	-	15	15	15	150
200	15	40	-	45	-	20	20	15	200
250	20	50	-	55	-	25	25	18	250
320	20	45	45	50	25	25	25	18	320



Hengshui JingTong Rubber Co., Ltd.



E-Mail: sales@jointwaterstop.com

www.jointwaterstop.com